

iLC

Intelligent Built-in Luminaire Controller

For efficient control of street and urban lighting

- OLC LonMark® profile
- Can address max. up to 4 operating devices
- Integrated relay
- Stand-alone or remote-control
- Individually programmable and updateable



The interoperable iLC luminaire controller is designed for use in street and urban lighting. It controls magnetic and electronic operating devices fitted with a 1-10 V or digital luminaire control interface via standardised powerline communication based on the OLC LonMark® profile.

iLC is intended for installation in luminaire on top or in a junction box at the bottom of the pole.

With the iLC, environmental factors such as reduction of energy consumption and thus lower CO₂ emissions are taken into account as well as the opportunity to adapt the light level according to the needs.

iLC detects failures and follows consumption in remote-controlled version. Up to 10 dimming levels with individual dimming sequences in stand-alone mode are possible.

Any external sensor can be added thanks to dry-contact input.



For stand-alone operation without central management

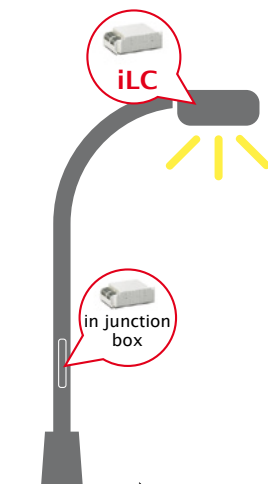

For remote control with central management

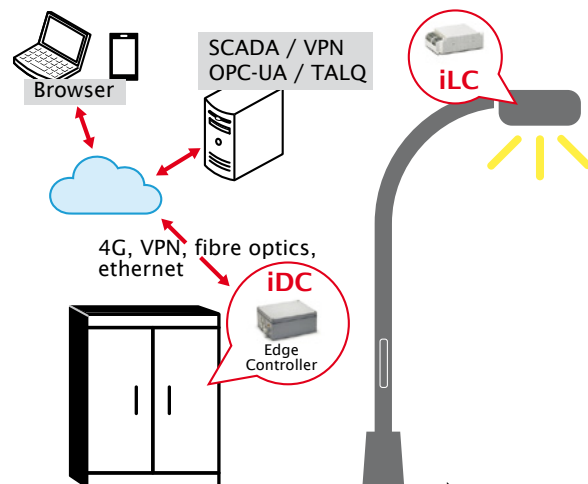

Dimensions (mm)

L 93 mm / W 58 mm / H 29 mm

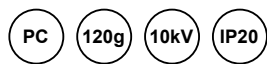
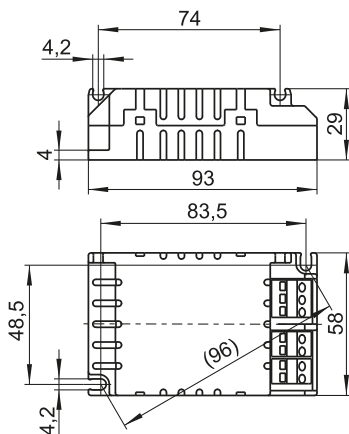

iLC-100	
Ref. No.	200003
Mains voltage/frequency	110-240 V AC (± 10%), 50/60 Hz
Power consumption	1-3 W
Communication	via powerline in acc. with CENELEC 50065-1, class 2 acc. to 2000/299/EC
Band	primary band (C) 125-140 kHz, secondary band (B) 95-125 kHz
Standard compliance	EN 14908-1, ANSI/CTA 709.1 and EN 14908-3, ANSI/CTA 709.2
LonMark® OLC profile	Interoperable, use of mandatory network variables and configuration parameters, repeatable
Galvanic isolation	No electrical isolation from input to output (as soon as the electronic device is connected to the iLC, the control input ceases to be electrically isolated)
Switching current	4 A (at λ = 0.8)
Control output	short-circuit proof, switchable 1-10 V, PWM or digital interface (1200 Bit/s, serial asynchronous, 8 mA voltage level 16 V); addressing range of the digital interface: max. 4 ballasts
Firmware update	via powerline
Control parameters	Switch on and off, dimming
Operating temperature range	-25 to +80 °C
Storage temperature range	-25 to +85 °C
Humidity	90% non-condensing
Mean time between failure	50,000 h
Luminaire protection class	Suitable for luminaires of protection class I and II
Connection terminals	for single, stranded leads: 0.5-1.5 mm ²

Typical application fields



Functions

- Dimming ON/OFF
- Delayed switching off or early switching on of the lighting in the closer area of pedestrian crossing zones for safety reasons.
- Maintenance factor function to ensure a constant luminous flux over the lamp lifetime.
- Using the control input (e.g. with a push button or motions ensor) the system can be switched to a certain lighting level for a freely configurable period of time.
- Intelligent switching time dimming for stand-alone operation (up to 10 dimming levels and sequences).

Measured data

- Voltage
- Current
- Power factor
- Power consumption
- Energy
- Temperature
- Operating hours with an accuracy of better than 1%

For more detailed information please visit our website www.iciti.de/en/ilc-luminairecontroller/

